

Wafer Type Butterfly Valve,UL/ULC Listed,FM Approved

Model No.:WD-371X



Technical Specifications:

- 1.Maximum Working Pressure:300PSI(Max.Test Pressure:600PSI)
- 2.Maximum Working Temperature:250 °F (120 °C)
- 3.Application: Indoor and Outdoor Use
- 4.Double-Seal Disc:Resilient EPDM Coated
- 5.Factory Installed Supervisory Tamper Switch Assembly

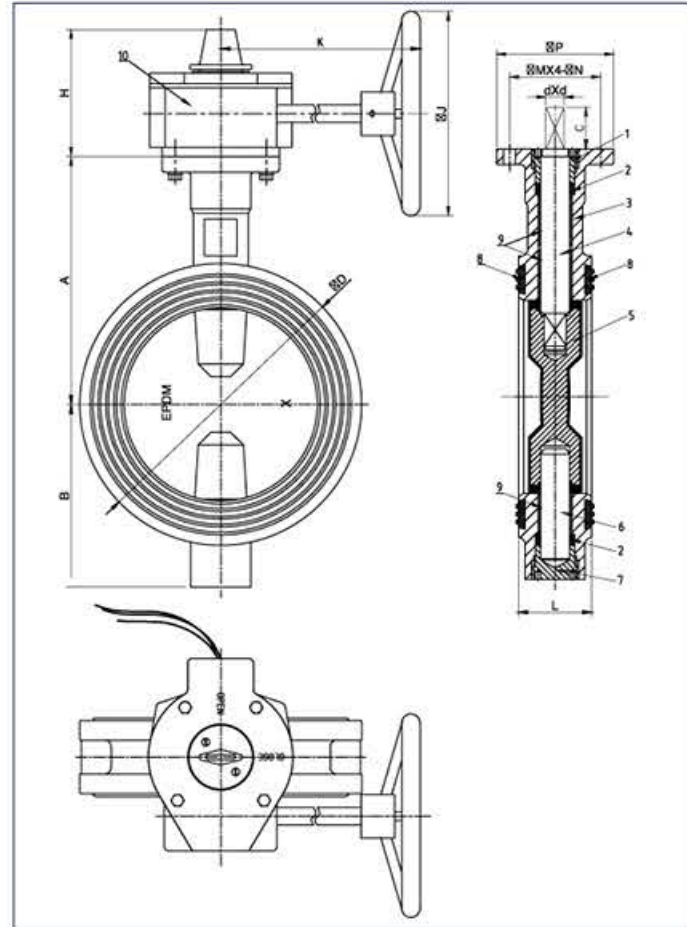

SIZE CHART

ITEM SIZE	A	B	C	D	H	K	J	P	M	N	d	L	
2"	110	85	32	100	111	153	218	152	90	70	9	10	42
2-1/2"	125	95	32	112	111	153	218	152	90	70	9	10	44.2
3"	140	100	32	120	111	153	218	152	90	70	9	11	45.3
4"	160	100	32	161	111	153	218	152	90	70	9	14	52
5"	170	125	32	182	111	153	218	152	90	70	9	14	54.4
6"	190	140	32	216	111	153	218	200	90	70	9	16	55.8
8"	230	175	32	260	126	210	232	300	125	102	12	19	60.5
10"	260	200	45	320	126	210	232	300	125	102	12	24	66.5
12"	300	240	45	375	161	249	350	150	125	14	26	76.9	

Carried Standard	
Design Standard	API609
Face to Face Standard	ASME B16.10
Top flange Standard	ISO 5211
Test Standard	FM1112 / UL1091

NO.	Name	Material
10	Signal Gearbox	DI
09	Stem Bushing	PTFE
08	End Face Seal	EPDM
07	Lower Shaft Sealing Nut	WCB
06	Lower Shaft	SS416
05	Disc	DI+EPDM
04	Upper Shaft	SS416
03	Body	DI
02	Shaft Seal	EPDM
01	Upper Shaft Sealing Nut	WCB

Grooved Type Butterfly Valve,UL/ULC Listed,FM Approved

Model No.:GD-381X



Technical Specifications:

- 1.Maximum Working Pressure:300PSI(Max.Test Pressure:600PSI)
- 2.Maximum Working Temperature:250 °F (120 °C)
- 3.Application: Indoor and Outdoor Use
- 4.Double-Seal Disc:Resilient EPDM Coated
- 5.Factory Installed Supervisory Tamper Switch Assembly

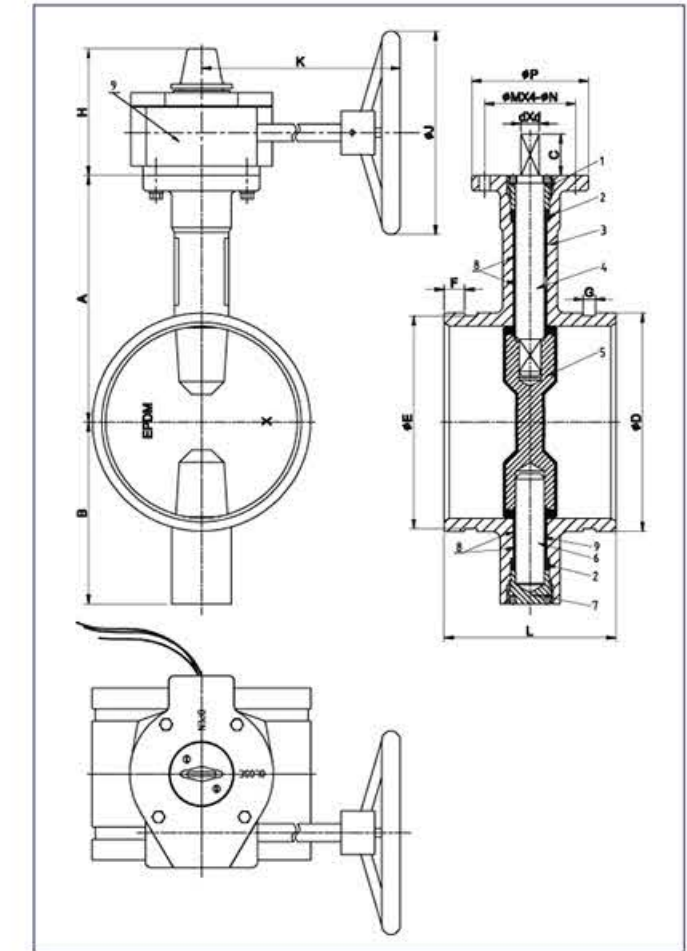

SIZE CHART

ITEM SIZE	A	B	C	D	E	F	G	H	K	J	P	M	N	d	L	
2"	110	85	32	60.3	57.15	15.9	7.9	111	218	153	152	90	70	9	10	88
2-1/2"	125	95	32	73	69.1	15.9	7.9	111	218	153	152	90	70	9	10	96.4
3"	140	100	32	76.1	72.3	15.9	7.9	111	218	153	152	90	70	9	11	97
4"	160	100	32	88.9	84.9	15.9	7.9	111	218	153	152	90	70	9	14	115.1
5"	170	125	32	114.3	110.1	15.9	9.5	111	218	153	152	90	70	9	14	115.1
6"	190	140	32	139.7	135.5	15.9	9.5	111	218	153	152	90	70	9	14	132.4
8"	230	175	32	141.3	137	15.9	9.5	111	218	153	152	90	70	9	14	132.4
10"	260	200	45	165.1	160.9	15.9	9.5	111	218	153	200	90	70	9	16	132.4
12"	300	240	45	168.3	164	15.9	9.5	111	218	153	200	90	70	9	16	132.4
				216.3	211.6	19	11.1	126	232	210	300	125	102	12	19	147.4
				219.1	214.4	19	11.1	126	232	210	300	125	102	12	19	147.4
				267.4	262.6	19	12.7	126	232	210	300	125	102	12	24	159
				273	268.3	19	12.7	126	232	210	300	125	102	12	24	159
				318.5	312.9	19	12.7	161	249	350	150	125	14	26	165	
				323.8	318.3	19	12.7	161	249	350	150	125	14	26	165	

Carried Standard	
Design Standard	API609
Groove Standard	ANSI/AWWA C606
Top flange Standard	ISO5211
Test Standard	FM1112 / UL1091

NO.	Name	Material
09	Signal Gearbox	DI
08	Stem Bushing	PTFE
07	Lower Shaft Sealing Nut	WCB
06	Lower Shaft	SS416
05	Disc	DI+EPDM
04	Upper Shaft	SS416
03	Body	DI
02	Shaft Seal	EPDM
01	Upper Shaft Sealing Nut	WCB

Fire Protection Butterfly Valve,UL/ULC Listed

Model No.:HFGD-381X / HGD-381X-175

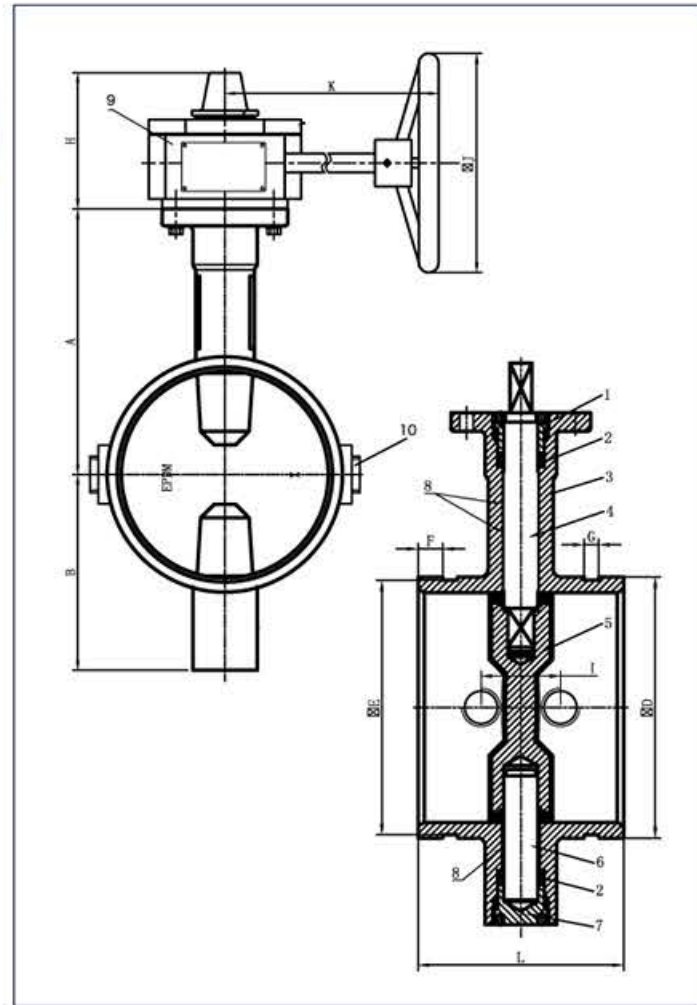

SIZE CHART

ITEM SIZE	A	B	C	D	E	F	G	H	K	J	L
2.5"	125	95	32	73 76.1	69.1 72.1	15.9	7.9	111	153	152	152.4
3"	140	100	32	88.9	84.9	15.9	7.9	111	153	152	158.8
4"	160	100	32	114.3	110.1	15.9	9.5	111	153	152	168.4
6"	190	140	32	165.1 168.3	160.7 164	15.9	9.5	111	153	200	177.8
8"	230	175	32	216.3 219.1	211.6 214.6	19	11.1	126	230	290	203
10"	260	200	45	267.4 273	262.6 268.3	19	12.7	126	230	290	203

Carried Standard	
Design Standard	API609
Groove Standard	ANSI / AWWA C606
Top Flange Standard	ISO 5211

NO	Name	Material
10	Plug	C95400
09	Signal Gearbox	DI
08	Stem Bushing	C95400
07	Lower Shaft Sealing Nut	WCB
06	Lower Shaft	SS416
05	Disc	DI+EPDM
04	Upper Shaft	SS416
03	Body	DI
02	Shaft Seal	EPDM
01	Upper Shaft Sealing Nut	WCB

Dry Barrel Fire Hydrant

Model No.:MH-XFS

Technical requirements

- 1.Design standard:ANSI / AWWA C502.
- 2.Nominal pressure:250PSI.
- 3.Connecting thread of fire truck is 4.5-4NH.
2 thread connector of hose is 2.5-7.5NH.
- 4.Flange connector:DIN 2501 PN16 / ASME B16.5 CLASS150

	DN100	DN150	
A	150 PN16	190.5 240	241.3 240
B	150 PN16	19	23
D	150 PN16	100	150
L	200	240	

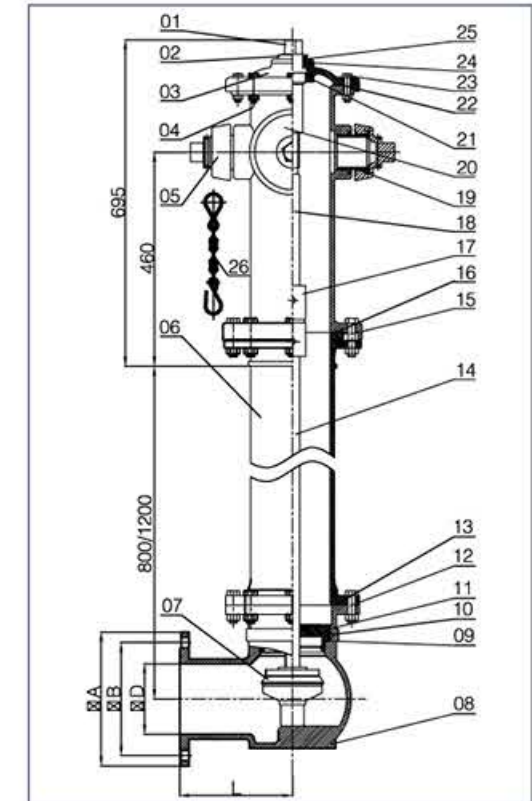

NO.	NAME	QTY
01	Drive Rod	1
02	Screw Nut Seat	1
03	Upper End Cover	1
04	Main Body On Ground	1
05	Coupling DN65	2
06	Connecting Cylinder	1
07	Sealing Seat	1
08	Connecting Flange	1
09	Sealing Ring	1
10	Seat Cover	1
11	Sealing Ring	1
12	Bolt	8
13	Sealing Ring	1
14	Lower Connecting Rod	1
15	Bolt	8
16	Sealing Ring	1
17	Connection Rod Sleeve	1
18	Upper Connecting Rod	1
19	Couping DN100	2
20	Cover DN100	1
21	Sealing Ring	1
22	Seal Gasket	1
23	Bolt	8
24	Sealing Ring	1
25	Sealing Ring	2
26	Cover Chain	3